

The Evolution SK100  
Chuck fitted with  
C Dovetail Jaws –  
Code 410161



All British-made super precision chuck system packed with innovation and accuracy.

- **Stainless steel body for durability and longevity**
- **Accessory Mounting Jaws with safety screw feature**
- **Compatible with our full range of jaw sets**
- **Made in our manufacturing facility in Axminster, United Kingdom**



#### 5 Year free Axminster Chuck Guarantee

Together with Axminster's 3 year guarantee on Machinery, it's probably the most comprehensive free guarantee ever. Unlike others it covers both professional and domestic usage. See terms and conditions online.



**Axminster Tools,**  
Weycroft Avenue, Axminster, Devon EX13 5PH

To see our extensive range of chuck accessories visit one of our stores,  
call **03332 406406** or search **axminstertools.com**

AXMINSTER  
woodturning



Featuring Unique  
**SafetyJaw**  
Rounded Corners



AXMINSTER  
woodturning

## Introduction

Welcome to your Evolution SK100 50th Anniversary Chuck from Axminster Tools. Here are the instructions to maintain your chuck, how it works and ensure the chuck and components remain clean and free from wear for a long life.

## Safety instructions for chucks

When using this chuck please follow these basic safety precautions:

**DO** ensure the chuck is screwed fully onto the headstock shaft.

**DO** ensure that all accessory fittings are secure before starting your lathe.

**DO** start the machine in a slow speed if the work is unbalanced.

**DO** make sure the chuck key is removed from the chuck before switching on.

**DO** be aware that when gripping large diameter workpieces that the jaws may extend beyond the boundary of the chuck body.

**DO** keep your hands clear until the chuck has stopped rotating.

**DO NOT** attempt to exceed the normal capacity of any jaw fitted to the chuck as the jaws may not fully engage the scroll if they are extended too far.

**DO NOT** run your lathe in reverse, unless you have purchased the Reverse Locking Chuck.

## Axminster Woodturning Jaws

There are a wide range of woodturning jaws for the Evolution SK100 Chuck available on our website.

All Axminster jaws are compatible with this chuck.



Visit [axminstertools.com](http://axminstertools.com)



- |   |                  |                               |               |                                  |                    |
|---|------------------|-------------------------------|---------------|----------------------------------|--------------------|
| 1 | Chuck Body       | 6                             | <b>951425</b> | Backplate Torx 20 Securing Screw |                    |
| 2 | <b>106818</b>    | SK100 Accessory Mounting Jaws | 7             | <b>APT009226</b>                 | Backplate          |
| 3 | <b>APT009225</b> | Pinion Gear                   | 8             | <b>951349</b>                    | Pinion Locking Pin |
| 4 | <b>951437</b>    | Hardened Scroll               |               | <b>108521</b>                    | Standard Chuck Key |
| 5 | <b>104062</b>    | Circlip                       |               |                                  |                    |

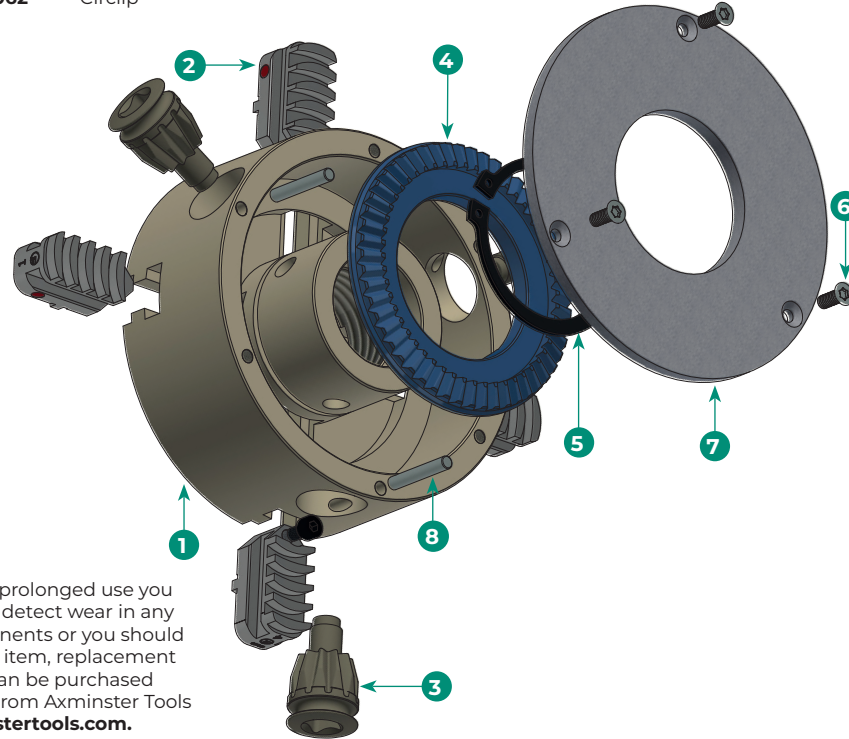

If after prolonged use you should detect wear in any components or you should lose an item, replacement parts can be purchased direct from Axminster Tools [axminstertools.com](http://axminstertools.com). If you have any questions, contact [technicalsupport@axminstertools.com](mailto:technicalsupport@axminstertools.com)



## Axminster Accessory Mounting Jaws

Manufactured in Axminster, these jaws are a precision fit for your chuck.

They feature a safety screw which prevents the jaws being extended too far from the chuck body. The screw is located on jaw 4 and must be in place before use.

Look out for the red dot on the side of all 4 jaws. If the dots are visible this means the screw is not in place and the jaws have been extended too far.

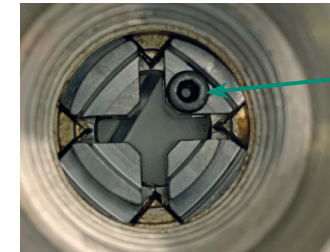

Look through the back of the chuck to see the screw. To remove the mounting jaws, first remove the safety screw **A**.



Evolution SK100 Accessory Mounting Jaws - Code 106818

